

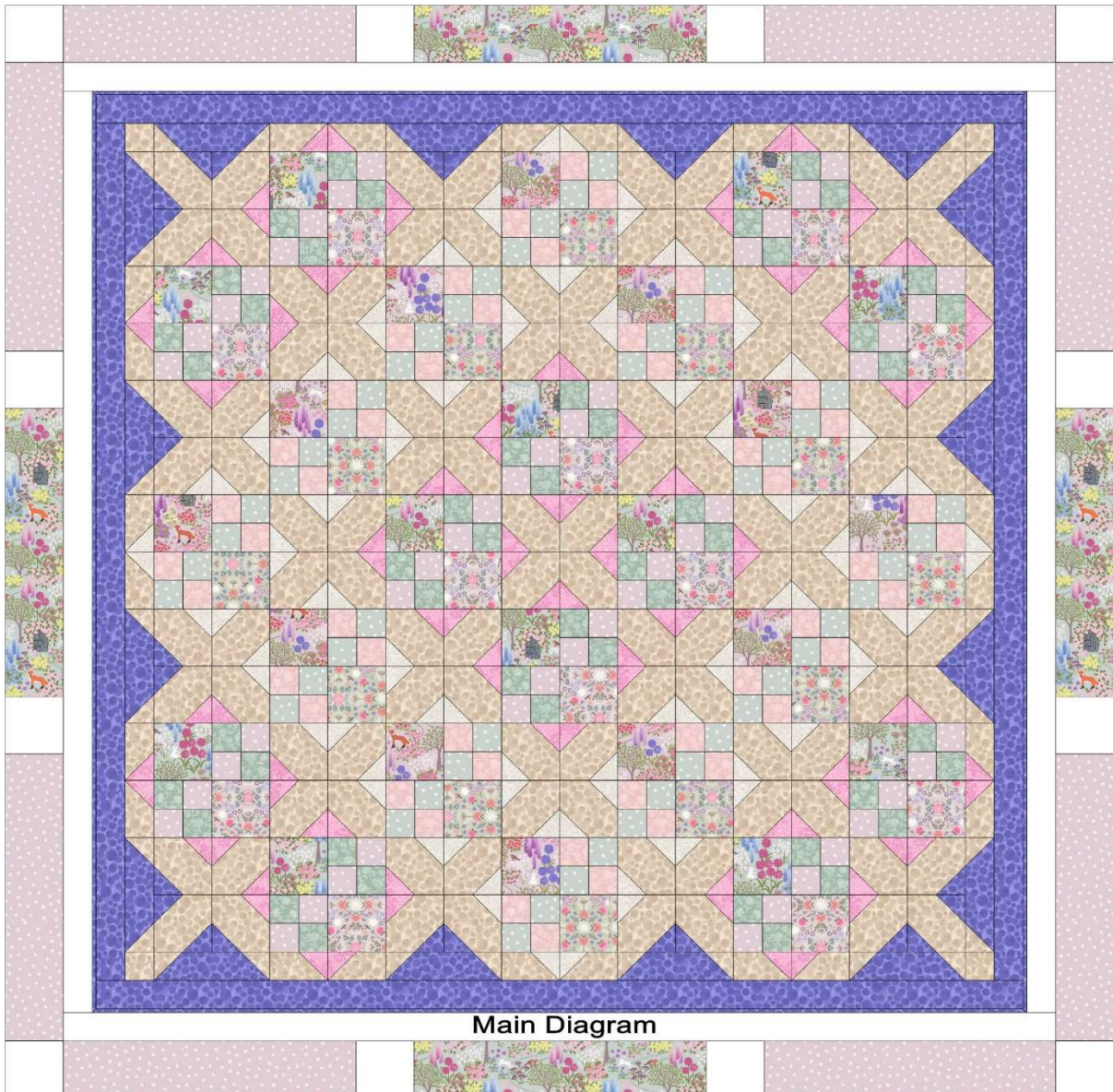

Designed and made by Sally Ablett Quilt 1

Size of quilt 64" x 64" - unfinished block size 8½" x 8½"



Requirements

Fabrics from the **Secret Garden** collection

1. A704.1 - The secret garden on duck green - long $\frac{1}{4}$
2. A705.2 - Daisies on muted lilac - long $\frac{1}{4}$
3. A706.3 - Roses on sage - long $\frac{1}{4}$
4. A707.3 - Hydrangea pink - $\frac{1}{2}$ yd
5. A708.2 - Robin floral on light beige - long $\frac{1}{4}$
6. A704.3 - The secret garden on muted lilac - long $\frac{1}{4}$
7. A705.1 - Daisies on duck egg - long $\frac{1}{4}$
8. A706.2 - Roses on muted rose - long $\frac{1}{4}$
9. A707.1 - Hydrangea light neutral - $\frac{1}{2}$ yd
10. A708.3 - Robin floral on muted sage - long $\frac{1}{4}$
11. BB331 - Light Beige - 2yd - 2m
12. BB340 - Cornflower - $1\frac{1}{4}$ yd - 1.20m

Wadding and backing 68" x 68"

**All measurements include $\frac{1}{4}$ " seam allowances; press each seam as you go.
You need to join your fabric to get the length for the border strips.**

Cutting

From fabric 1 cut	-	From fabric 6 cut
12 x $4\frac{1}{2}$ " x $4\frac{1}{2}$ "	-	12 x $4\frac{1}{2}$ " x $4\frac{1}{2}$ "
From fabric 2 cut	-	From fabric 7 cut
48 x $2\frac{1}{2}$ " x $2\frac{1}{2}$ "	-	48 x $2\frac{1}{2}$ " x $2\frac{1}{2}$ "
From fabric 3 cut	-	From fabric 8 cut
48 x $2\frac{1}{2}$ " x $2\frac{1}{2}$ "	-	48 x $2\frac{1}{2}$ " x $2\frac{1}{2}$ "
From fabric 4 cut	-	From fabric 9 cut
96 x $2\frac{1}{2}$ " x $2\frac{1}{2}$ "	-	96 x $2\frac{1}{2}$ " x $2\frac{1}{2}$ "
From fabric 5 cut	-	From fabric 10 cut
12 x $4\frac{1}{2}$ " x $4\frac{1}{2}$ "	-	12 x $4\frac{1}{2}$ " x $4\frac{1}{2}$ "

From fabric 11 cut

100 x 4½" x 4½"

24 x 2½" x 4½"

36 x 2½" x 2½"

From fabric 12 cut

6 x 2½" x WOF

32 x 2½" x 4½"

32 x 2½" x 2½"

16 x 2½" x 8½" cut 45° angle from left and right corners ***



Diagram for cutting angle ***

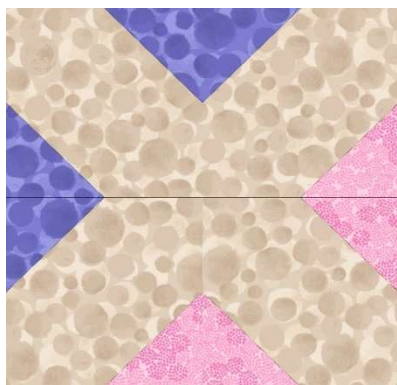

Block 1



Block 2

Draw a diagonally line on the back of fabrics 4,9, 11 and 12.

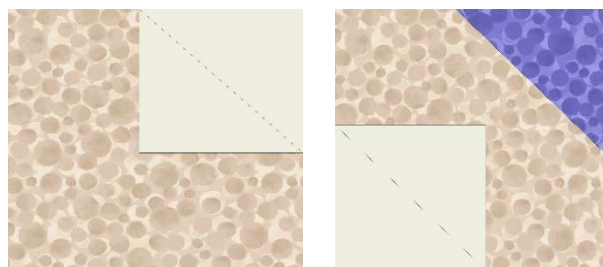

Place a small square onto the larger square. Stitch on the outer edge of the pencil line. Trim away a ¼" on the out edge of the stitch line. Do the same to the other side. Look at the main diagram for the placement of fabric in each block.

Block 2 - Lay out the fabric pieces for each block as in the main diagram. Sew the small squares together and then stitch in rows to complete the block.

Complete the quilt

Lay out all the blocks as in the main diagram. Sew in rows, pressing your seams in the opposite way each time as this will help when sewing the rows together.



The first 3 Rows of the quilt center. Look at the placement for each of the blocks in the quilt as you sew the rows.

Border

Inner border

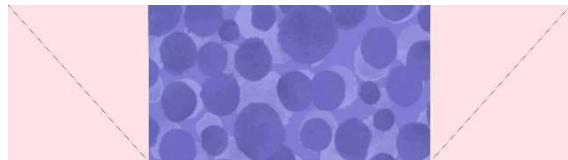
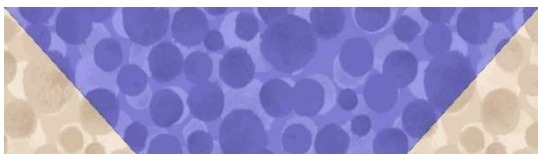

Draw a diagonally line on the back of fabrics 11.

As before place a small square onto the strip. Stitch on the outer edge of the pencil line. Trim away a $\frac{1}{4}$ " on the out edge of the stitch line. Do the same to the other side. Look at the main diagram for the placement of fabric in each block. You need 16 in total.

Next block

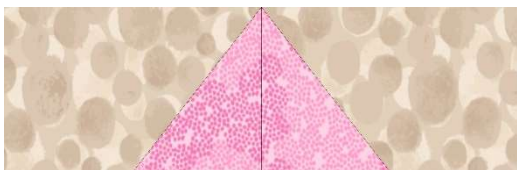

A



B

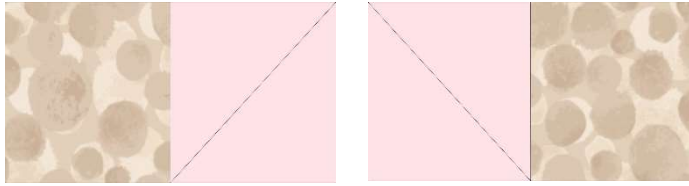

Draw a diagonally line on the back of fabrics 4. Same as before with the squares. Join the two strips together to complete the block.

You need 8 of block A and 4 of block B.

Lay out the inner border as in the main diagram and sew the strips together 7 for the sides. Add to the quilt. On the top and bottom strip add a square to each end and sew to the quilt.

Outer border

You need to join your strip to get the length for your border.

2 x 2½" x 60½" Stitch to the sides of the quilt.

2 x 2½" x 64½" Sew the strips to the top and bottom of the quilt.



Sandwich the quilt top, wadding and backing together.

Quilt by hand or machine as desired. Trim the backing and wadding to size of quilt.



Use your favorite method from fabric 12 to bind the quilt.





1

Designed and made by Sally Ablett Quilt 2

Size of quilt 64" x 64" - unfinished block size 8½" x 8½"

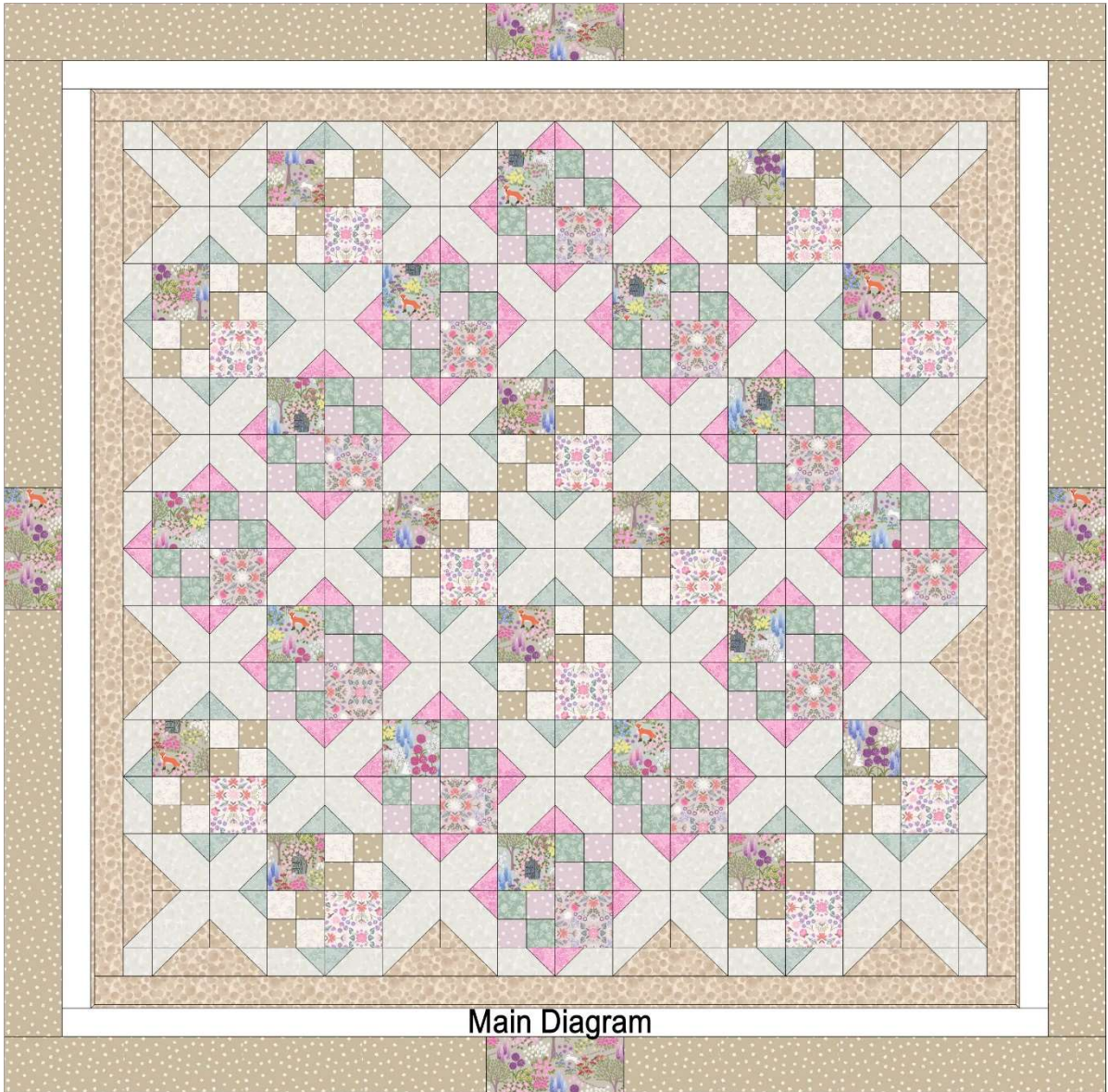

Main Diagram

Requirements

Fabrics from the Secret Garden collection

1. A704.2 - The secret garden on soft neutral - long $\frac{1}{4}$
2. A705.3 - Daisies on dark neutral - long $\frac{1}{4}$
3. A706.1 - Roses on cream - long $\frac{1}{4}$
4. A707.2 - Hydrangea duck egg - $\frac{1}{2}$ yd
5. A708.1 - Robin floral on cream - long $\frac{1}{4}$
6. A704.1 - The secret garden on duck green - long $\frac{1}{4}$
7. A705.2 - Daisies on muted lilac - long $\frac{1}{4}$
8. A706.3 - Roses on sage - long $\frac{1}{4}$
9. A707.3 - Hydrangea pink - $\frac{1}{2}$ yd
10. A708.2 - Robin floral on light beige - long $\frac{1}{4}$
11. BB40 - Cream - 2yd - 2m
12. BB331 - Light Beige - $1\frac{1}{4}$ yd - 1.20m

Wadding and backing 68" x 68"

**All measurements include $\frac{1}{4}$ " seam allowances; press each seam as you go.
You need to join your fabric to get the length for the border strips.**

Cutting

From fabric 1 cut	-	From fabric 6 cut
12 x $4\frac{1}{2}$ " x $4\frac{1}{2}$ "	-	12 x $4\frac{1}{2}$ " x $4\frac{1}{2}$ "
From fabric 2 cut	-	From fabric 7 cut
48 x $2\frac{1}{2}$ " x $2\frac{1}{2}$ "	-	48 x $2\frac{1}{2}$ " x $2\frac{1}{2}$ "
From fabric 3 cut	-	From fabric 8 cut
48 x $2\frac{1}{2}$ " x $2\frac{1}{2}$ "	-	48 x $2\frac{1}{2}$ " x $2\frac{1}{2}$ "
From fabric 4 cut	-	From fabric 9 cut
96 x $2\frac{1}{2}$ " x $2\frac{1}{2}$ "	-	96 x $2\frac{1}{2}$ " x $2\frac{1}{2}$ "
From fabric 5 cut	-	From fabric 10 cut
12 x $4\frac{1}{2}$ " x $4\frac{1}{2}$ "	-	12 x $4\frac{1}{2}$ " x $4\frac{1}{2}$ "

From fabric 11 cut

100 x 4½" x 4½"

24 x 2½" x 4½"

36 x 2½" x 2½"

From fabric 12 cut

6 x 2½" x WOF

32 x 2½" x 4½"

32 x 2½" x 2½"

16 x 2½" x 8½" cut 45° angle from left and right corners ***



Diagram for cutting angle ***



Block 1



Block 2

Draw a diagonally line on the back of fabrics 4,9, 11 and 12.

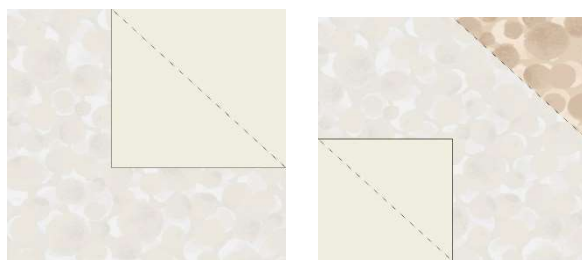

Place a small square onto the larger square. Stitch on the outer edge of the pencil line. Trim away a ¼" on the out edge of the stitch line. Do the same to the other side. Look at the main diagram for the placement of fabric in each block.

Block 2 - Lay out the fabric pieces for each block as in the main diagram. Sew the small squares together and then stitch in rows to complete the block.

Complete the quilt

Lay out all the blocks as in the main diagram. Sew in rows, pressing your seams in the opposite way each time as this will help when sewing the rows together.



The first 3 Rows of the quilt center. Look at the placement for each of the blocks in the quilt as you sew the rows.

Border

Inner border

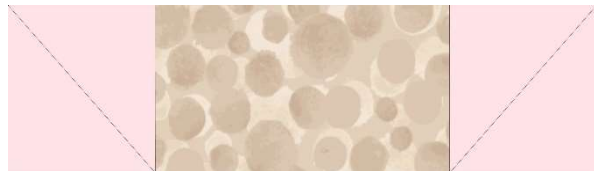

Draw a diagonally line on the back of fabrics 11.

As before place a small square onto the strip. Stitch on the outer edge of the pencil line. Trim away a $\frac{1}{4}$ " on the out edge of the stitch line. Do the same to the other side. Look at the main diagram for the placement of fabric in each block. You need 16 in total.

Next block

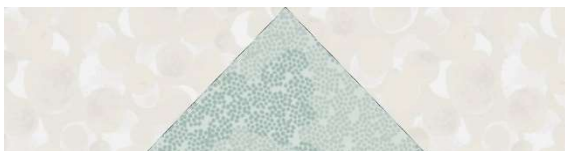

A

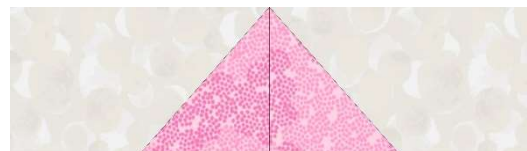

B

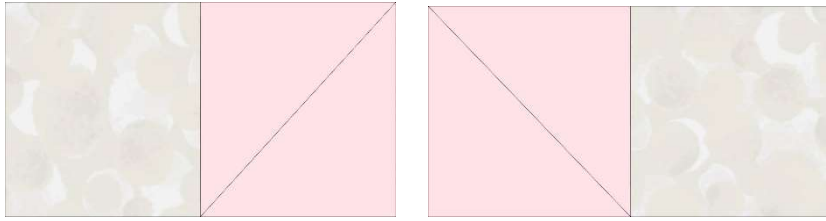

Draw a diagonally line on the back of fabrics 4. Same as before with the squares. Join the two strips together to complete the block.

You need 8 of block A and 4 of block B.

Lay out the inner border as in the main diagram and sew the strips together 7 for the sides. Add to the quilt. On the top and bottom strip add a square to each end and sew to the quilt.

Outer border

You need to join your strip to get the length for your border.

2 x 2½" x 60½" Stitch to the sides of the quilt.

2 x 2½" x 64½" Sew the strips to the top and bottom of the quilt.



Sandwich the quilt top, wadding and backing together.

Quilt by hand or machine as desired. Trim the backing and wadding to size of quilt.



Use your favorite method from fabric 12 to bind the quilt.



Sally Ablett 2023 ©